



# Property Information Sheet

## Franklin School



Hennepin County Property Info - 2004 Aerial Photos

SITE INFORMATION		BUILDING INFORMATION		NEIGHBORHOOD CHARACTERISTICS	
<b>Address:</b>	1501 - Aldrich Avenue N Minneapolis, MN 55411	<b>Year Constructed:</b>	1970	<b>Surrounding Area Type:</b>	(N) Mixed use (S) Commercial (E&W) Residential
<b>Property ID:</b>	16-029-24-44-0043	<b>Major Additions:</b>	None	<b>Major Intersections:</b>	• Plymouth Ave N & Lyndale Ave N • West Broadway Ave & Lyndale Ave N
<b>Approximate Parcel Size:</b>	370,931 SF	<b>Building Size:</b>	125,794 SF	<b>Vicinity to Freeway:</b>	Access to I 94 & 394 • 5 minutes to downtown Minneapolis
<b>Grade Level:</b>	6-8	<b>Number of Floors:</b>	2	<b>Public Transportation:</b>	Yes Metro Transit Route 7&22
<b>Zoning:</b>	R2B/Two Family District	<b>Classrooms:</b>	35		
<b>Parking:</b>	North and South sides of building	<b>Media Center:</b>	Yes		
<b>Debt:</b>	\$1,396,107	<b>Gymnasium:</b>	Yes (2)		
		<b>With Storage:</b>	Yes		
		<b>Theater/Auditorium:</b>	Yes		
		<b>Cafeteria:</b>	Yes		
		<b>Kitchen:</b>	Yes Full Commercial		
		<b>Multi-Purpose Room:</b>	Yes -used as classroom or Auxiliary Gym		
		<b>Elevator:</b>	Yes		
		<b>Other Highlights:</b>			
		• Pool			
		• Boys & Girls Locker Room & Showers			

### AREA RESOURCES

- W. Broadway Commercial District
- Hall Park
- North Commons Park and Water Park
- Mississippi River and Parkway
- International Market Square
- Theodore Wirth Park and Wirth Beach
- Walker Art Center and Sculpture Garden
- Farmers Market
- Burgeoning Arts Community: Northside Arts Collective (NAC)
- Major Supermarket
- Sumner Library
- Summit OIC-Dunwoody Charter School
- North High School
- NorthPoint Health and Wellness Center
- Plymouth Industrial Corridor
- Minneapolis Community and Technical College
- Dunwoody College of Technology
- YMCA

First Floor

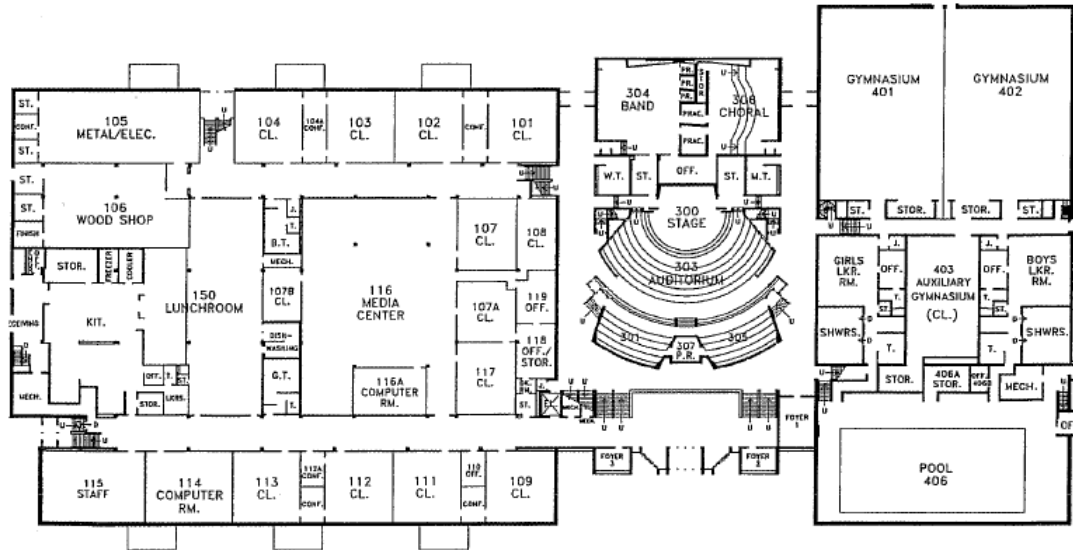

Second Floor

